

Base Heater Kit 설치 안내서

모델명 : AHC-015EB (150W)

안전을 위한 주의사항

본 설치안내서는 삼성 EHS HT 실외기에 사용되는 Base heater kit 설치에 대해 설명하고 있습니다. Base heater kit 설치 전 설치안내서를 충분히 읽고 바르게 설치해 주십시오. (제품 및 다른 선택사양 설치에 해당 설치안내서를 참조하십시오.)

- 경고** 지시사항을 지키지 않았을 경우 설치기사 또는 사용자가 사망하거나 중상을 입을 수 있습니다.
- 주의** 지시사항을 지키지 않았을 경우 설치기사 또는 사용자에게 부상이나 재산 피해가 발생할 수 있습니다.

경고

- 설치는 설치전문점이나 서비스센터에 의뢰하십시오.
- Base heater kit를 직접 개조하거나 수리하지 마십시오.
 - 고장, 감전, 화재의 위험이 있으므로, 수리할 필요가 있을 때는 설치전문점이나 서비스센터에 의뢰하십시오.
- Base heater kit를 철거 및 폐기할 경우에는 설치전문점이나 서비스센터에 문의하십시오.
- Base heater kit는 지정된 위치에 설치 부속품을 이용하여 견고하게 설치하십시오.
 - Base heater kit의 설치가 견고하지 않을 경우 부품이 떨어져 파손될 수 있습니다.

Base heater kit 설치 준비

부속품

Base heater(1)	고정 클립 (4)	고정 나사 (4) (클립 고정용)	고정 나사 (1) (PCB 고정용)	PCB & 와이어 (1)	설치안내서(1)

- 주의** Base heater kit를 설치할 때는 반드시 지정된 부품을 사용하십시오.

실외기 분해 방법

다음 순서와 같이 실외기를 분해하십시오.

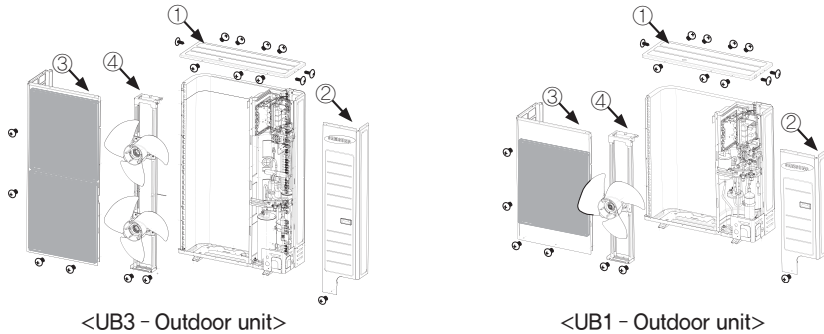

- 실외기 Top을 분리하십시오.
 - 실외기 우측 Front cover를 분리하십시오.
 - 실외기 좌측 Front cover를 분리하십시오.
 - 모터 브라켓을 분리하십시오.
- * 설치 완료 후, 위의 분해순서 반대로 조립하십시오.

Base heater kit 설치

- Base heater를 실외기 바닥에 설치 한 후 표시 부 4개소에 고정 클립과 고정 나사를 이용하여 조립하십시오.
- Base heater wire가 운전시 팬과 간섭이 없게, 모터 브라켓의 와이어를 이용하여 고정하십시오.
- 동봉된 PBA를 표시 부 Control box에 고정하십시오.

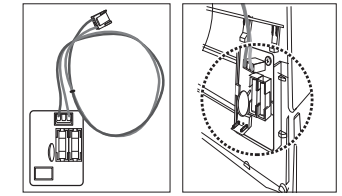
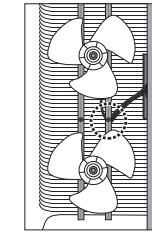
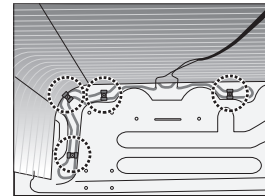

- 동봉된 고정 나사를 사용하여 1개소에 고정하십시오.
- Base heater connector (White)를 표기부에 고정하십시오.
- PBA connector(Blue)를 표기 부에 고정하십시오.

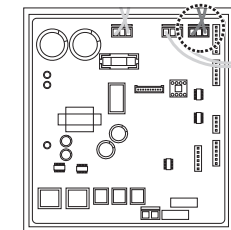
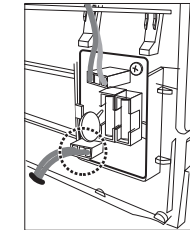
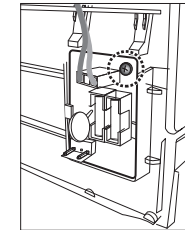

PBA 체결

Heater PBA 단자와 Main PBA 단자를 동봉된 와이어를 이용해 체결하십시오.

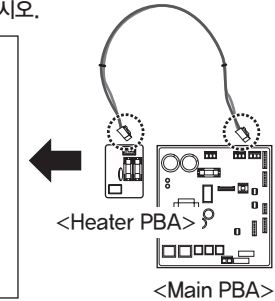
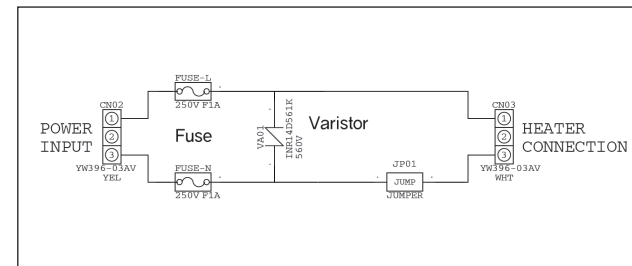

Code NO : DB68-03205A-02

Base Heater Kit installation manual

Model name : MHC-015EE (150W)

Safety precautions

This installation manual explains how to install the Base heater kit used in Samsung EHS HT. Read this installation manual thoroughly before installing the Base heater kit for proper installation. (For installing product or other optional accessories, refer to corresponding installation manual.)

- WARNING** Hazards or unsafe practices that may result in severe personal injury or death.
- CAUTION** Hazards or unsafe practices that may result in minor personal injury or property damage.

- WARNING**
 - ◆ Consult qualified installer or service center for installation.
 - ◆ Do not attempt to repair, disassemble, or modify the appliance yourself.
 - There is potential risk of product damage, electric shock or fire. When repair is needed, consult qualified installer or service center.
 - ◆ Contact qualified installer or service center when you need to remove or dispose the Base heater kit.
 - ◆ Firmly fix and install the Base heater kit on the designated location with the installation accessories.
 - If the Base heater kit is not firmly fixed, parts may fall apart and get damaged.

Preparing Base heater kit installation

Accessories

Base heater (1)	Fixing clips (4)	Fixing screws (4) (For fixing clips)	Fixing screw (1) (For fixing PCB)	PCB & wire (1)	Installation manual (1)

- CAUTION**
 - When installing the Base heater kit, you must use the designated accessories.

Disassembling the outdoor unit

Disassemble the outdoor unit in following order.

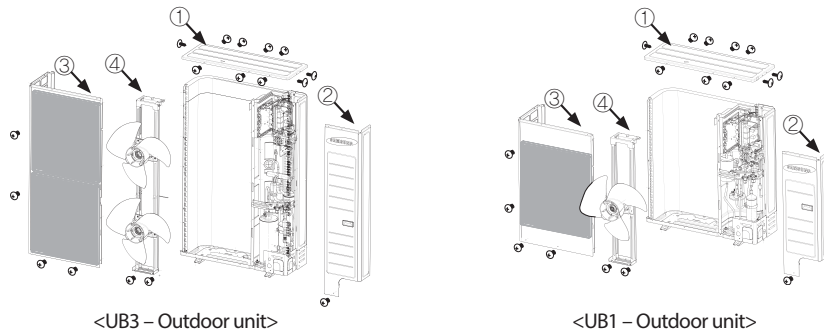

- ① Disassemble the top part of the outdoor unit.
 - ② Disassemble the front cover on the right side of the outdoor unit.
 - ③ Disassemble the front cover on the left side of the outdoor unit.
 - ④ Disassemble the motor bracket.
- ※ When the installation is complete, assemble the outdoor unit in reverse order.

Installing the Base heater kit

- ① Install the Base heater on the bottom part of the outdoor unit and fix 4 places with the fixing clips and fixing screws.
- ② To prevent the Base heater wire from interfering with the fan during operation, fix it to the motor bracket wire.
- ③ Fix the enclosed PBA on the control box as shown in the figure.

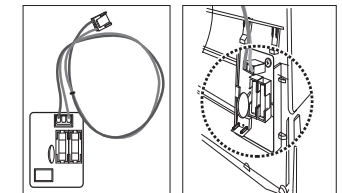
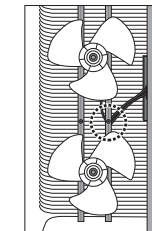
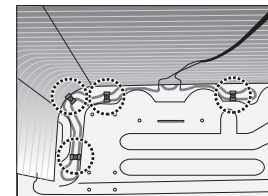

- ④ Use enclosed screw to fix 1 place on the PBA.
- ⑤ Connect the Base heater connector (white) as shown in the figure.
- ⑥ Connect the PBA connector (blue) as shown in the figure.

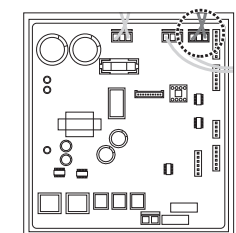
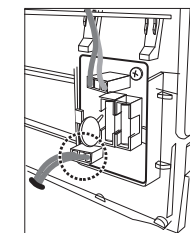
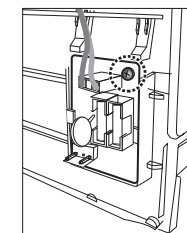

Connecting the PBA

Use enclosed wire to connect between Heater PBA terminal and Main PBA terminal.

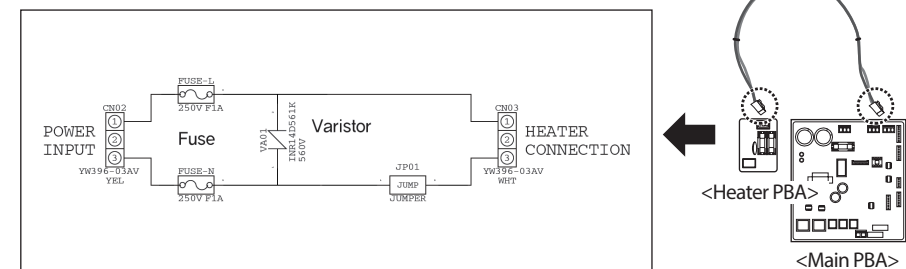

Code NO : DB68-03205A-02