

### **DANGER: Danger of death, serious personal injury and burns**

- This cable is designed exclusively for the discharging of specified Kia/Hyundai/Genesis electric vehicles. Do not use it for any other purpose
- Always refer to vehicle operating manual and follow vehicle manufacturer operating instructions
- Do not use discharging cable if it is defective or appears damaged
- Do not use discharging cable if there is corrosion to the contacts or pins
- Do not plug cable into damaged, corroded or loose power outlets or car sockets
- Do not expose electrical contacts directly to water
- Do not modify product
- Do not submerge in water
- Do not crush, fold, knot or pull the cable
- Ensure cable is not a tripping hazard during use
- Do not exceed rated discharge power output of your vehicle

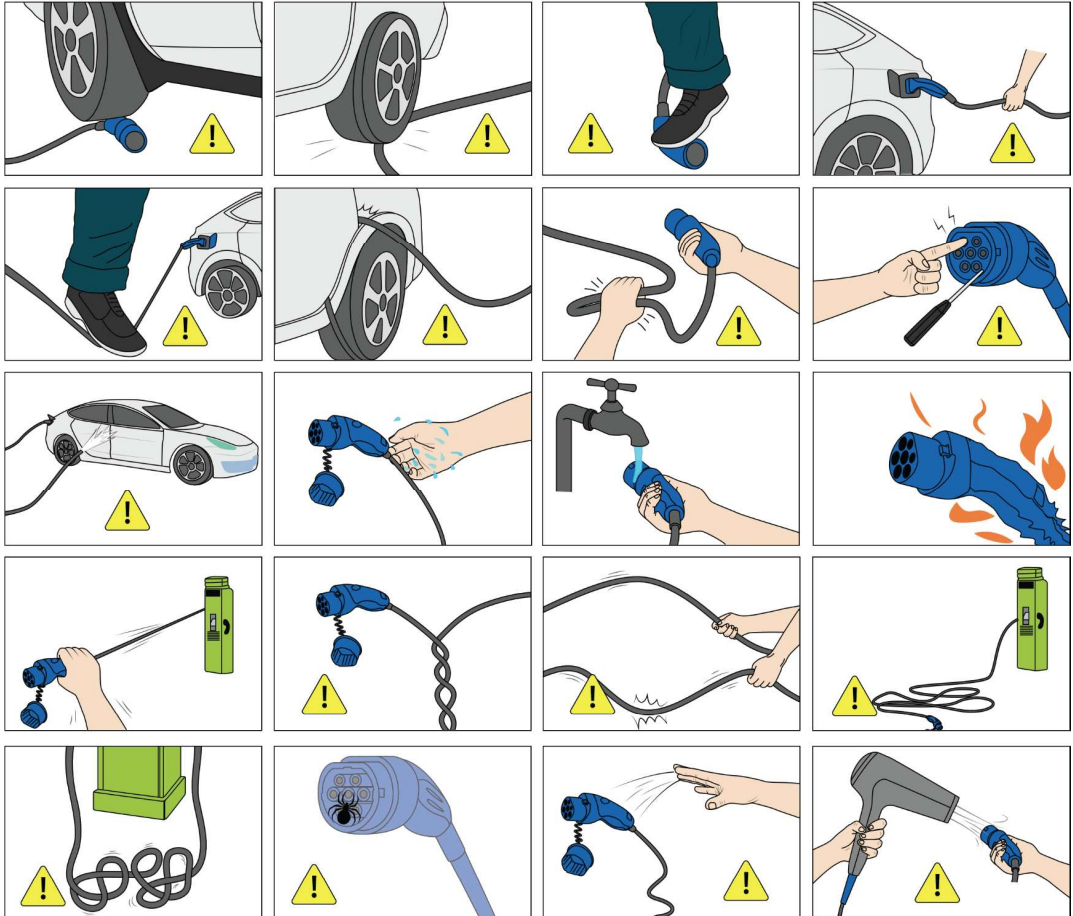

## Before Use

- Read all instructions & warnings carefully
- Check the specifications of your electric vehicle to ensure compatibility
- Fully uncoil lead prior to charging
- Check for damage, if damaged in any way DO NOT USE

## Operation

**To use the discharge function, follow the instructions below:**

1. Unlock the vehicle and access the AC charging port (the charging port is also the discharging port).
2. Insert the discharge gun connector into the discharge port socket.
3. Press the switch of the V2L connector which should start the discharge function.
4. The discharge may not turn on normally when the battery discharging limit is set higher than the current high voltage battery state of charge. You can see and adjust this setting in the energy consumption menu on the infotainment display.
5. To stop discharging, press the same button on the V2L connector that was used to initiate the discharging. At this time the electronic lock will automatically be released and the discharge gun can be removed. If the V2L connector does not release, the lock can be deactivated by pressing the door unlock button on the smart key
6. Make sure there is no debris or foreign matter in the charging port, fit the charging port cover and close the charging point door.

**Note:** Please connect the V2L connector to the charging hole within 60 seconds after the charging cover opens. To prevent theft after connecting, it is changed to auto lock automatically so that it is impossible to separate.

**Note:** When using V2L, cancel the scheduled air conditioning setting. V2L may not be available to operate if the scheduled air conditioning is being activated.

**Note:** V2L discharging mode will shut off if the vehicle is turned off using indoor V2L.

**Note:** Opening the charging door or connecting the V2L connector to the charging inlet, the V2L discharging mode will shut off. If you want to use the indoor and outdoor V2L simultaneously, firstly connect the V2L connector to the charging inlet and use the indoor V2L.

## Cleaning

- Only clean the charging cable when it is not connected to the vehicle or the charging station
- Clean the charging cable and dirty contacts with a dry cloth
- Never use abrasive cleaning agents, water jet or steam jet cleaners
- Never submerge the article in liquids

## Storage

- Store the charging cable with the protective dust caps on it in a dry and clean place

## Repair

- Do not attempt to repair cable

## Disposal

- Dispose of the charging cable separately from other waste

support@wottz.com

Wottz  
Park House, Mere Park, Dedmere Road  
Marlow, Buckinghamshire, SL7 1FJ

